

PM MOUNTING SCREW



Inclusive
Torx Bit

PM MOUNTING SCREW is used to fasten dimpled and drainage membranes to perimeter insulation made of pressure-resistant XPS insulation material. The plastic dowel has a coarse, conical thread and a TX 40 flat head drive.

The pressure-stable XPS perimeter insulation from 60 mm thickness must be firmly bonded to the water-proofing. Please follow the manufacturer's instructions for suitable adhesives.

Technical Data

| | |
|---------------------------|--|
| Material | Polypropylene |
| Dimensions | 55 mm length, 27 mm Ø head diameter |
| Drill hole to use as plug | Use 4,5 x 40 mm screws |
| Colour | White or black |
| Consumption | 1 PM MOUNTING SCREW / m ² |
| Temperature range | -30 °C to +80 °C |
| Delivery form | Packed in a box with 50 pieces or in a bag with 100 pieces, plus free Torx T40 bit |

For more information, visit www.pmi-plast.de

INSTALLATION INSTRUCTIONS

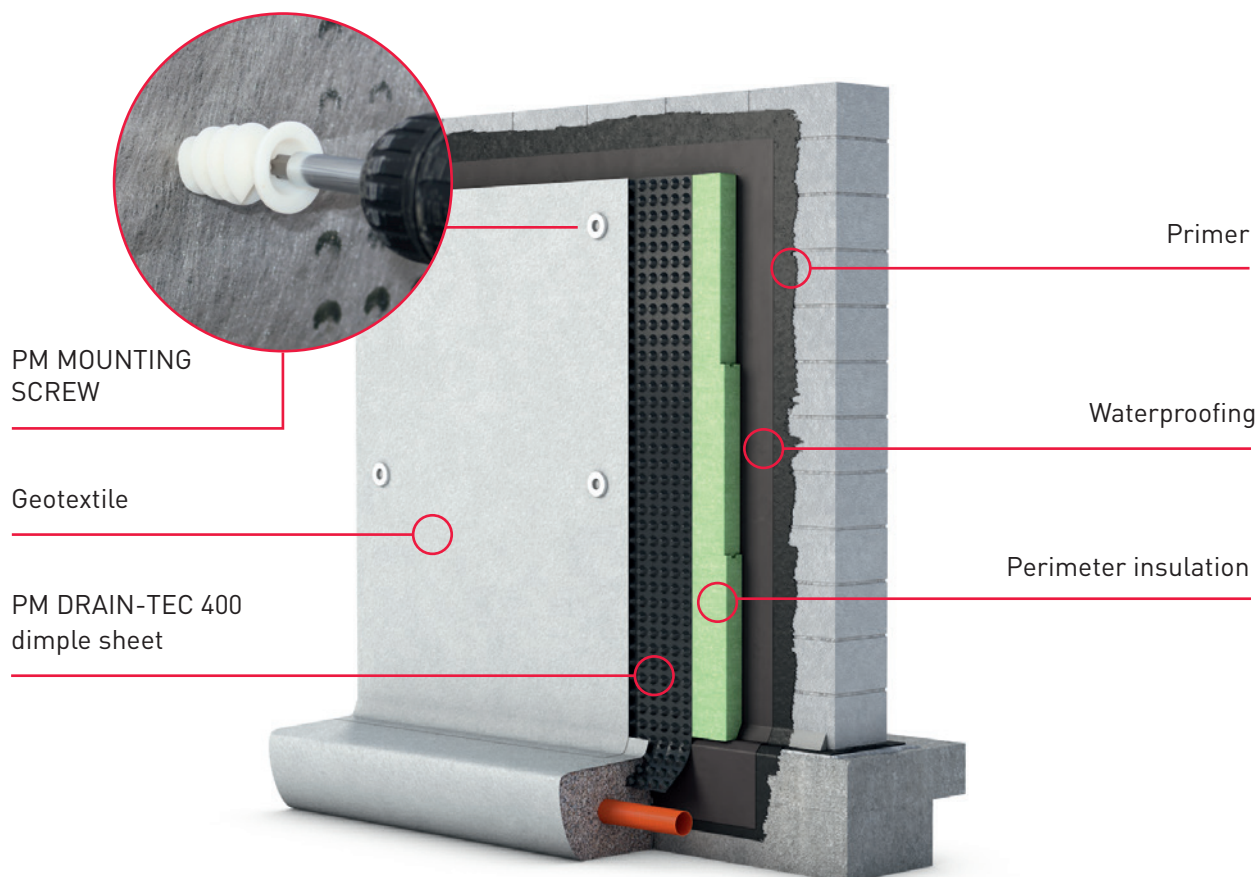

Application

The fastening is done on the complete insulated surface. The screws have a powerful high-torque Torx T 40 drive, a suitable steel Torx bit is included in each bag.

The screws are pressed directly through the geotextile and dimpled membrane and screwed into the perimeter insulation board with a cordless screwdriver; pre-drilling is not necessary.

Pre-select a low torque on the cordless screwdriver so that the screw is not overtightened.

Important: Insert additional screws at pipe or cable penetrations and light wells.

The PM MOUNTING SCREW can, of course, also be used as an insulation plug for ETICS, the screw has a corresponding hole on the inside for 4.5 mm screws. The edge of the screw should be sealed for ETICS after installation.

When backfilling, always backfill and compact in layers. If backfilling is not done properly in one go, the perimeter insulation may come loose!

For more information, visit www.pmi-plast.de