

PM PVC DAMP PROOF COURSE

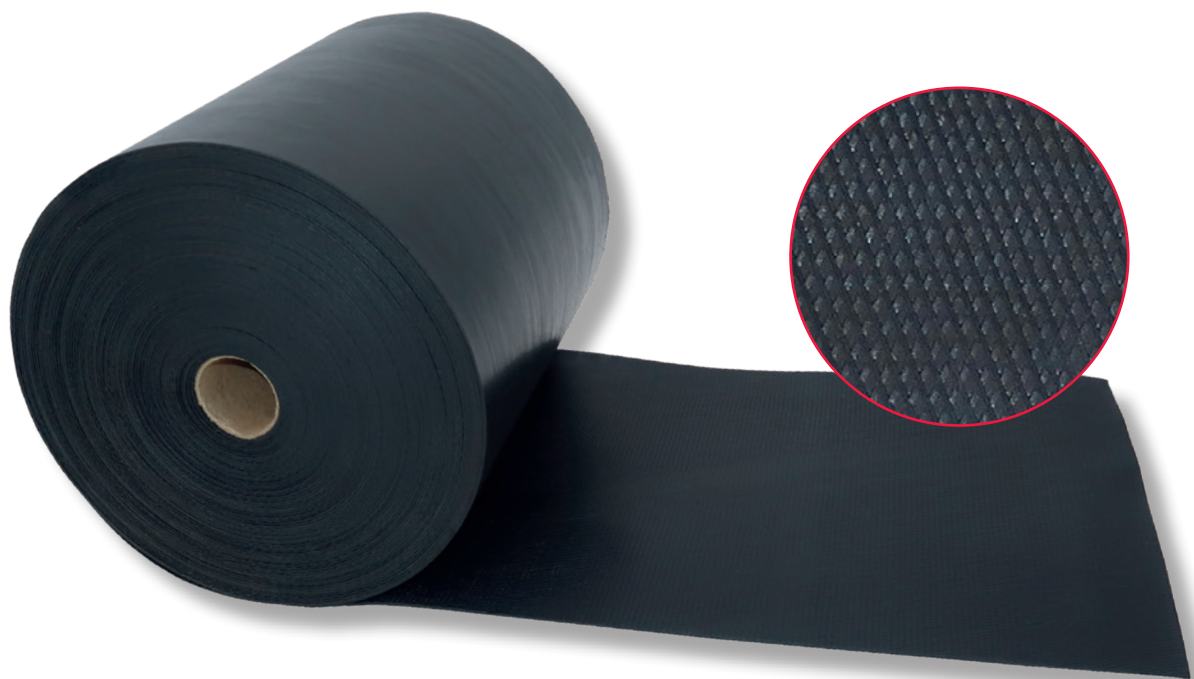

The PM PVC DAMP PROOF COURSE (DPC) is a 1.2 mm thick, DIN-compliant, highly elastic, watertight damp proof course and meets the requirements of DIN EN 14909, DIN V 20.000-202 and DIN 18533. It is permanently resistant to rising moisture and rot-proof, securely protecting the masonry from the ground up. The PM PVC DPC is used as a horizontal barrier layer installed in the lowest horizontal joint of the masonry between two mortar layers and can also be used as an L- or Z-barrier in a cavity wall. It can also be used in the area of wall openings, such as window openings, lintels or balustrades. The PM PVC DPC is UV-stabilised and is easy and efficient to install directly from the 25 m long roll. The PM PVC DPC allows compact storage at trade partner and processor locations. It can be glued with PM POWER FIX cartridge adhesive.

Technical Data

Material	PVC, soft
Colour	anthracite
Thickness	1.20 mm
Tear strength	long. approx. 18 N/mm trans. approx. 16 N/mm
Elongation at break	long. approx. 300 % trans. approx. 300 %
Root resistance	acc. to DIN 4062
Temperature resistance	-20 °C to +80 °C
Roll length	20 / 25 / 30 m
Roll width	0.115 / 0.175 / 0.240 / 0.300 / 0.365 / 0.500 / 0.600 / 0.750 / 1.00 / 1.20 / 1.50 m

For more information, visit www.pmi-plast.de

INSTALLATION INSTRUCTIONS

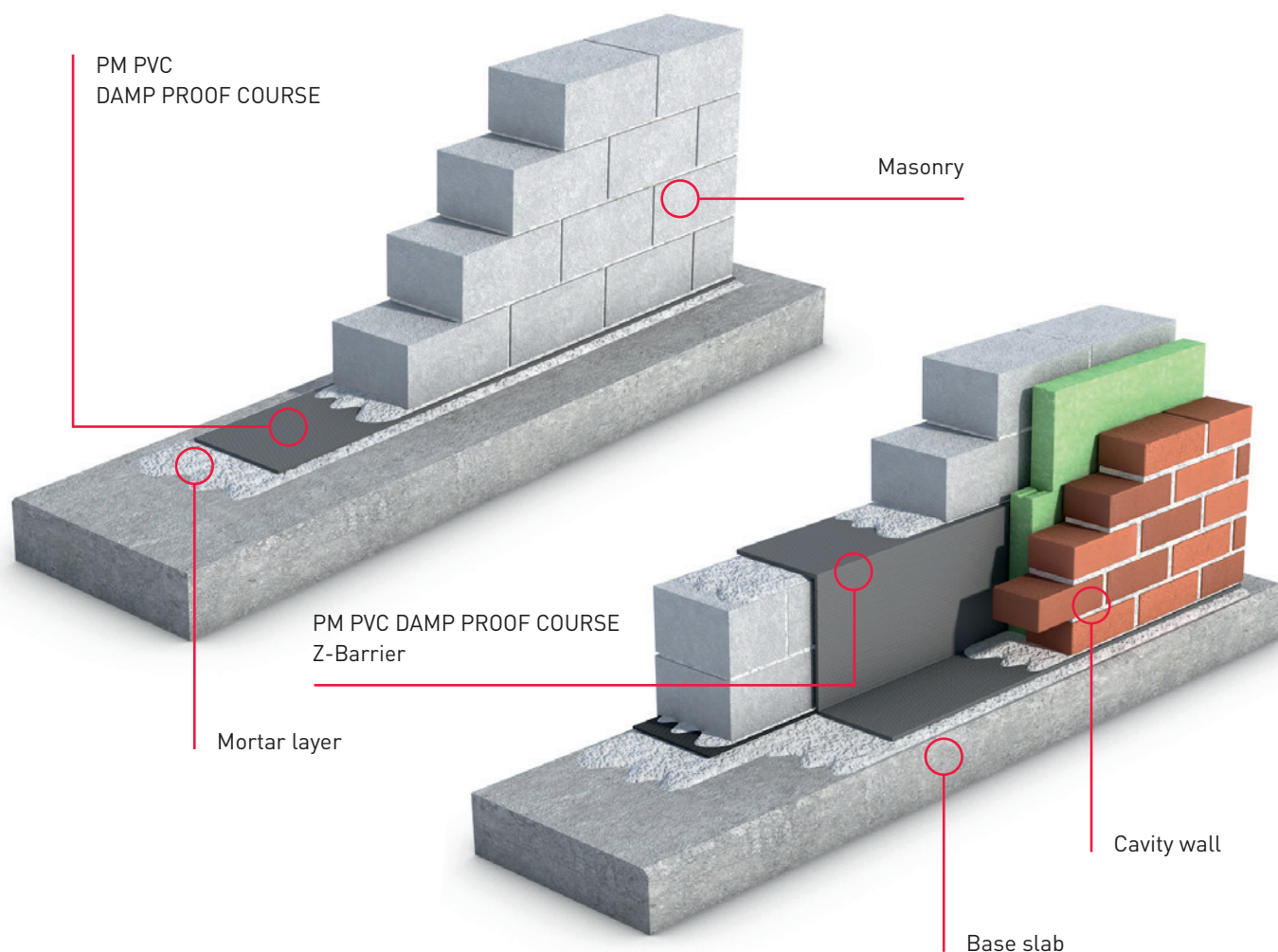

Installation instructions

The PM PVC DPC is laid in one layer. The surface must be levelled out using Group 2 or 3 mortar acc. to DIN 1053 in order to obtain an even surface. Then install the PM PVC DPC between two mortar layers under the first stone. At the joints, a sufficient overlap of 20 cm must be ensured. The width of the damp proof course

must be selected so that no moisture bridges can form to the side of the bricked-up wall. As an L-barrier in a cavity wall, the PM PVC DPC is glued to the rising masonry with PM POWER FIX. As an Z-barrier in a cavity wall, the PM PVC DPC is fit into the shell masonry, then later inserted into the facing shell.

Accessories:

PM BUTYL ADHESIVE TAPE | PM POWER FIX cartridge adhesive